

# KLS-01.1

## INSTALLATION MANUAL

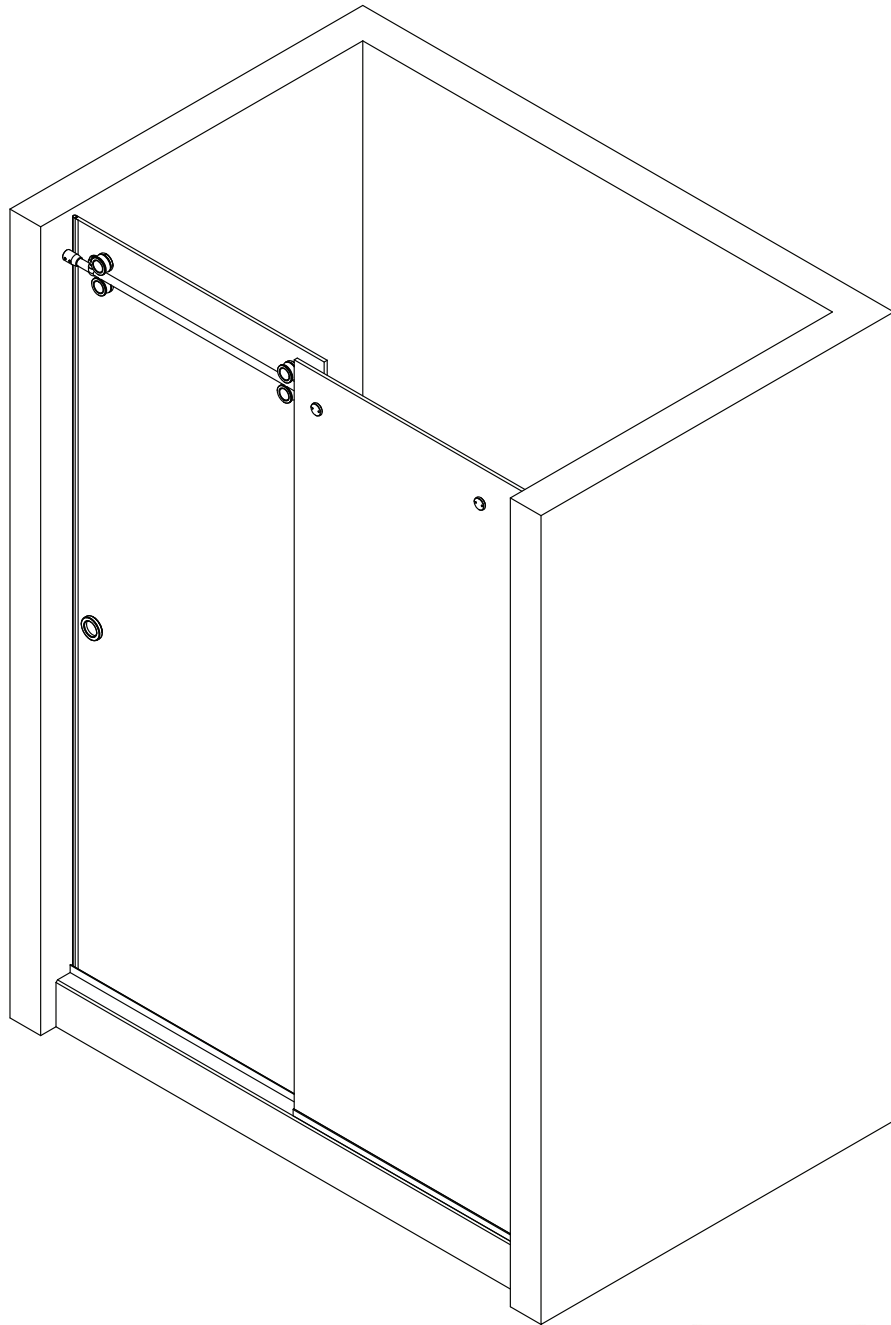

SLIDING SHOWER DOOR



EPCO USA  
ARCHITECTURAL  
HARDWARE  
SOLUTIONS

# PRODUCT INFORMATION

## PRODUCT CAPACITY:

- Maximum Door Weight: 40 KG (88 LBS)
- Maximum Door Width: 812 MM (32")
- Maximum Door Height: 1930 MM (76")

## STANDARD KLS-01.1:

Fits up to 60" wide opening.

## CUSTOM KLS-01.1.72:

Fits up to 72" wide opening with a wide fixed panel. Additional W-T glass fixings to support the fixed panel may be required.



## DANGER:

If this shower is installed with a cut-too-short track bar, wider fixed panel without extra W-T Fixings support, Bottom Anti-Lift Pins are not against the bar, misplaced stoppers, or slide the glass to hit the walls, THESE COULD RESULT IN SERIOUS INJURY.

## CONTACT INFORMATION:

EPCO focus on providing excellent products and services to all customers. For more information or if you have any questions regarding our products, please visit our website at [www.epcocorp.com](http://www.epcocorp.com) or contact us via email at [info@epcocorp.com](mailto:info@epcocorp.com). We're here to help!

# HARDWARE CONTAINS:

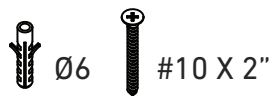

2X



2X



2X



2X

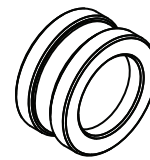

1X



2X



2X

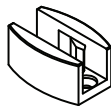

1X

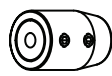

2X

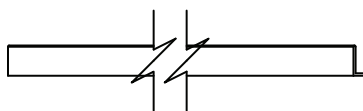

1X

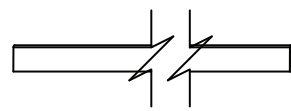

1X

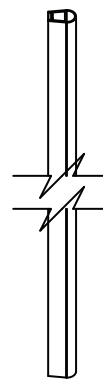

1X

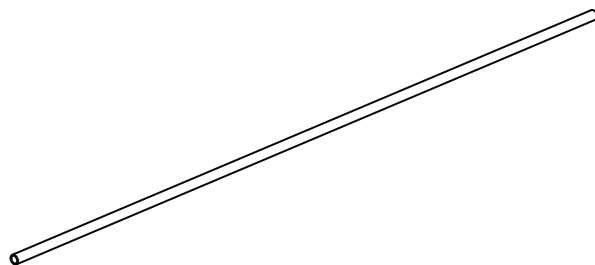

1X

## TOOLS REQUIRED:

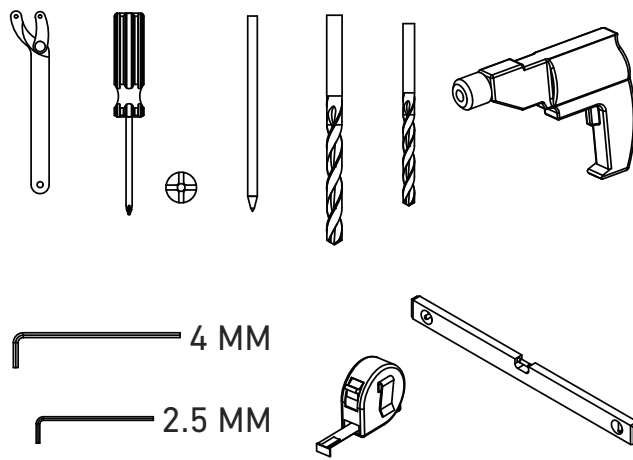

# GLASS TEMPLATE:

**STANDARD KD:**  
Fits up to 60" wide opening.

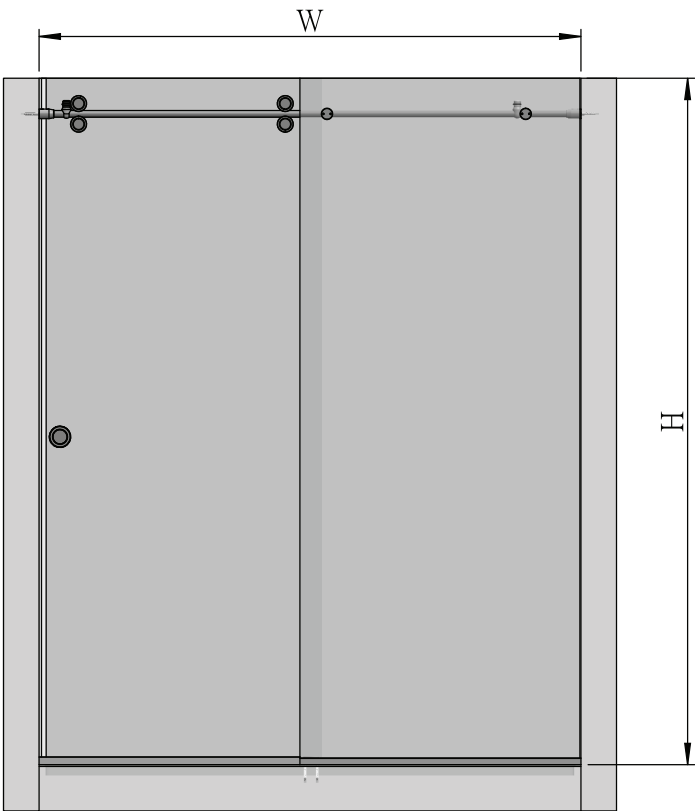

## DOOR PANEL

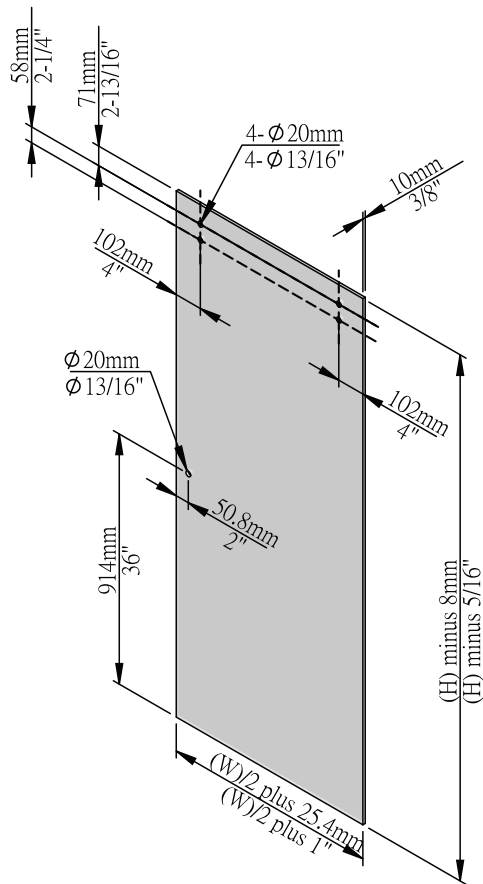

## FIXED PANEL

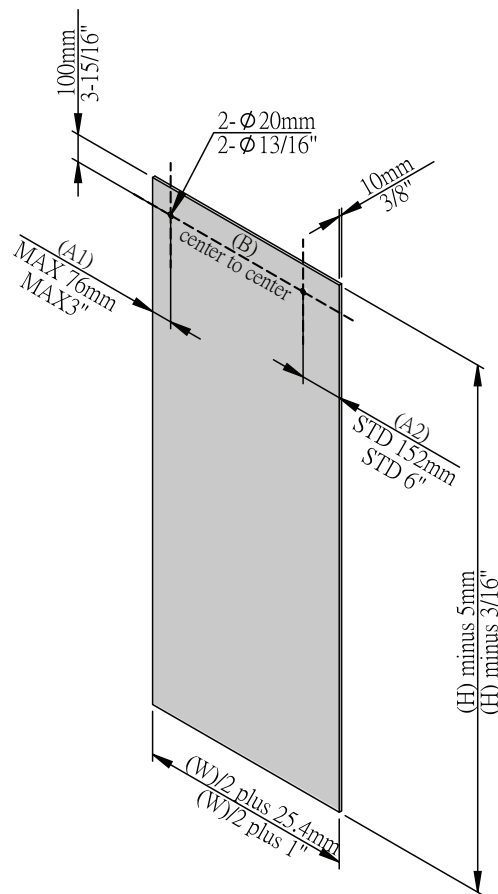

# INSTALLATION INSTRUCTIONS:

## STEP 1

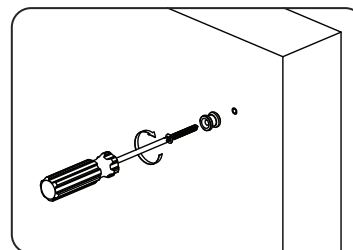
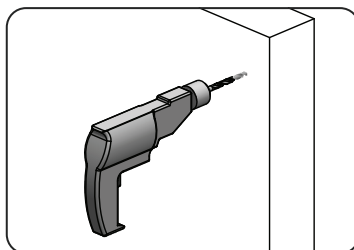
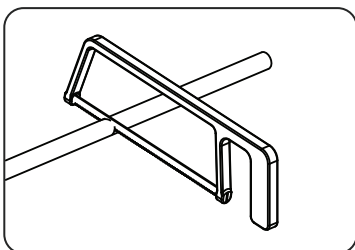
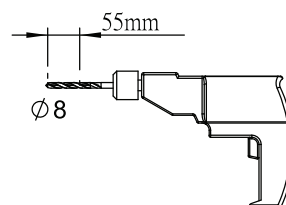
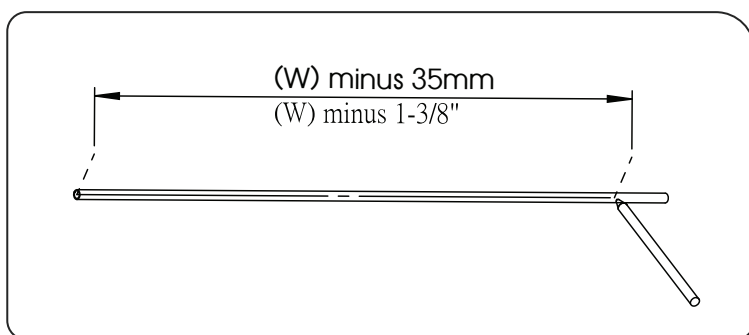
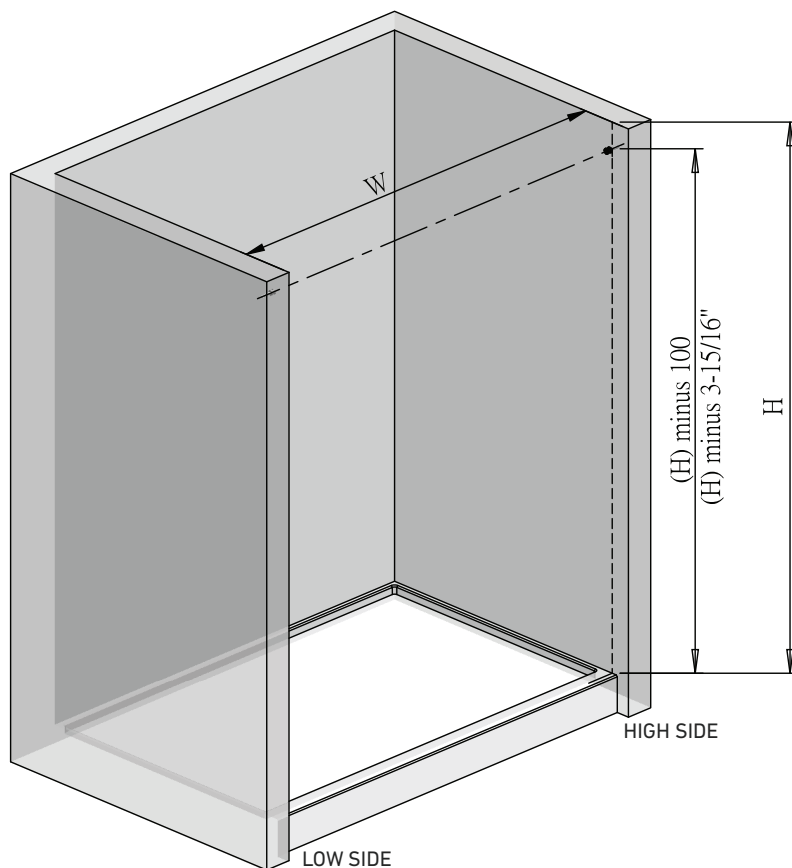

Mount wall fixing on high side of curb first. Level bar to mark opposite wall for second wall fixing.

## STEP 2

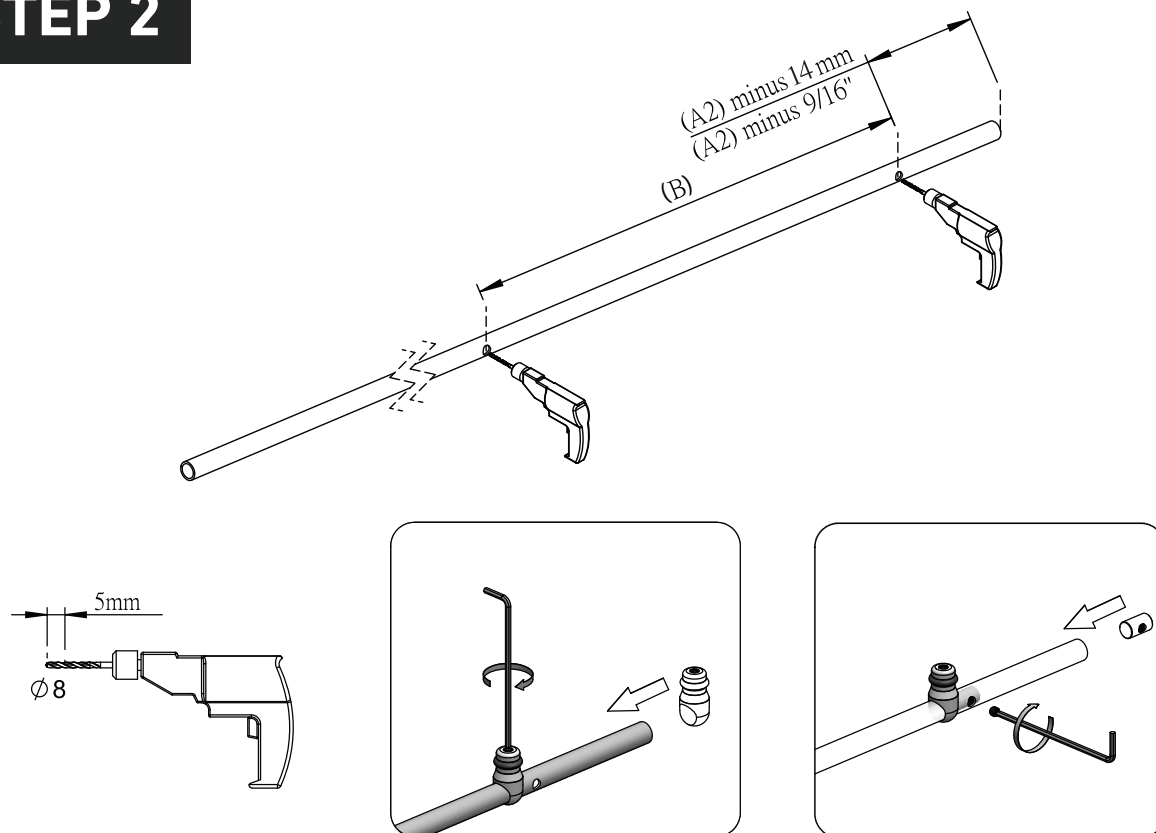

## STEP 3

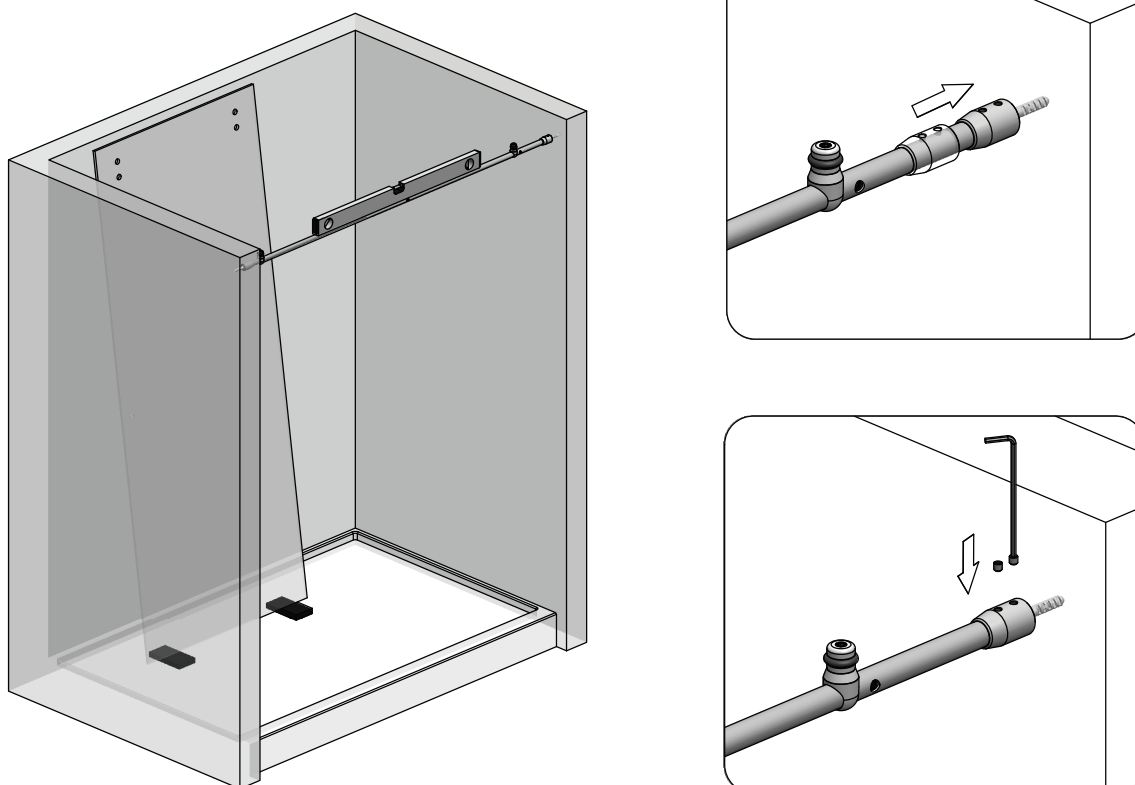

## STEP 4

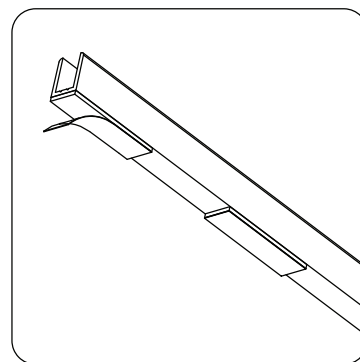
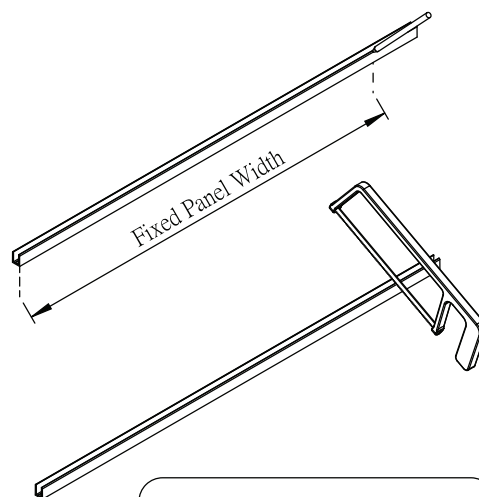
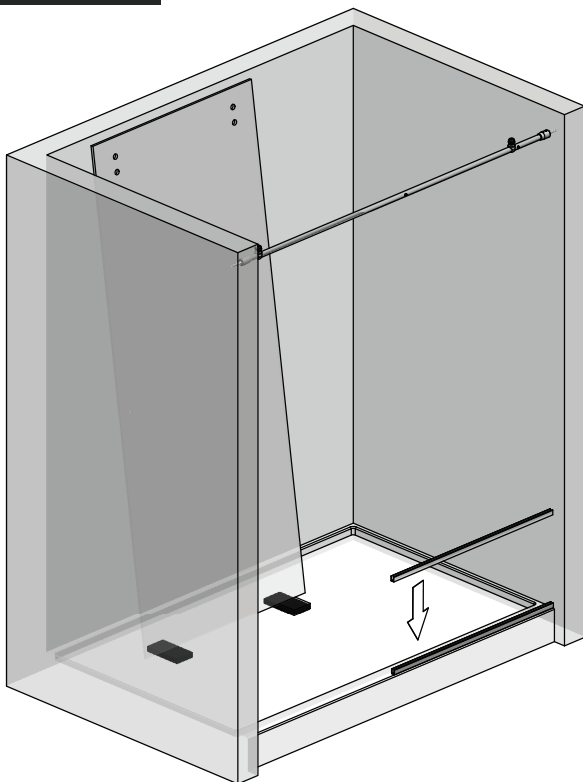

## STEP 5

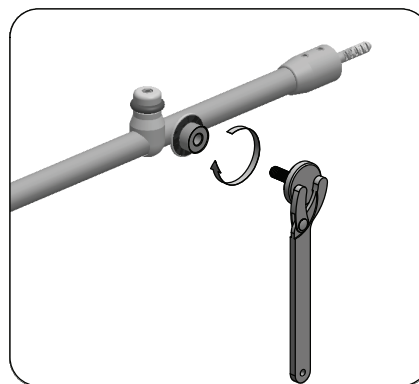
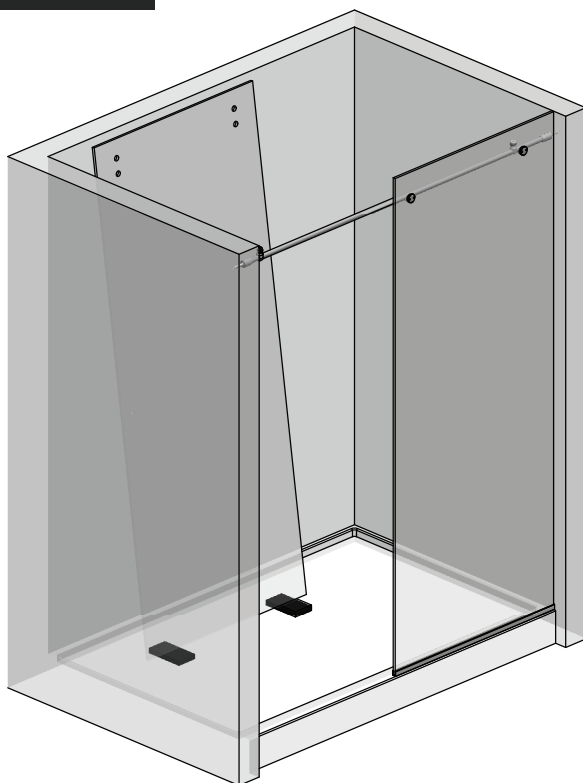

## STEP 6

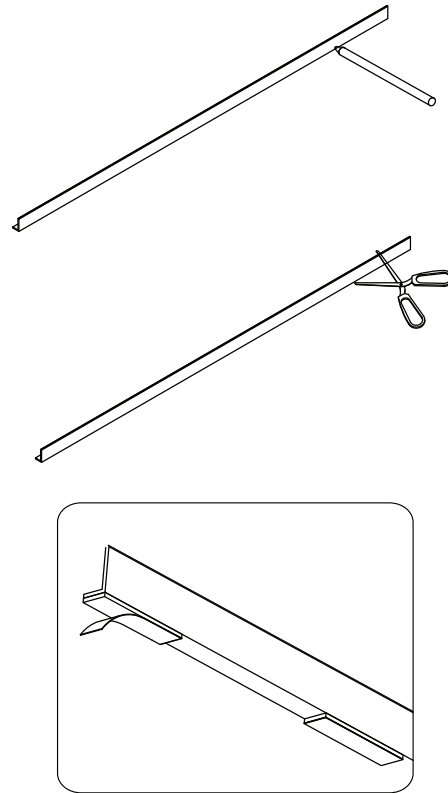
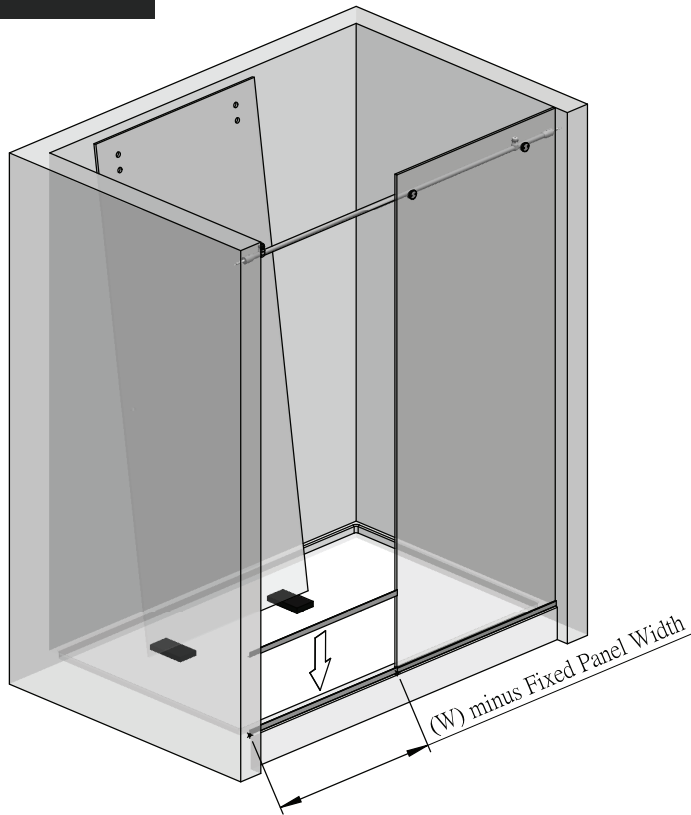

## STEP 7

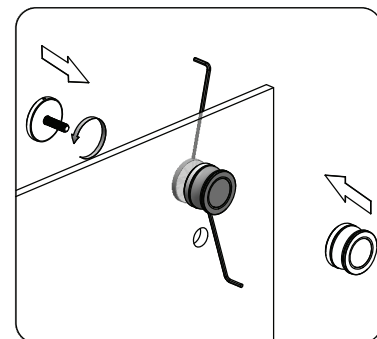
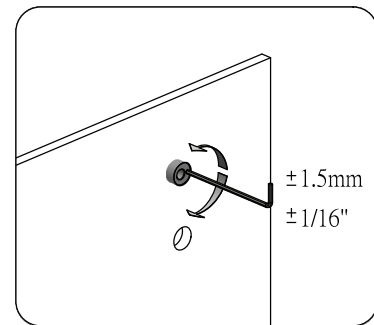
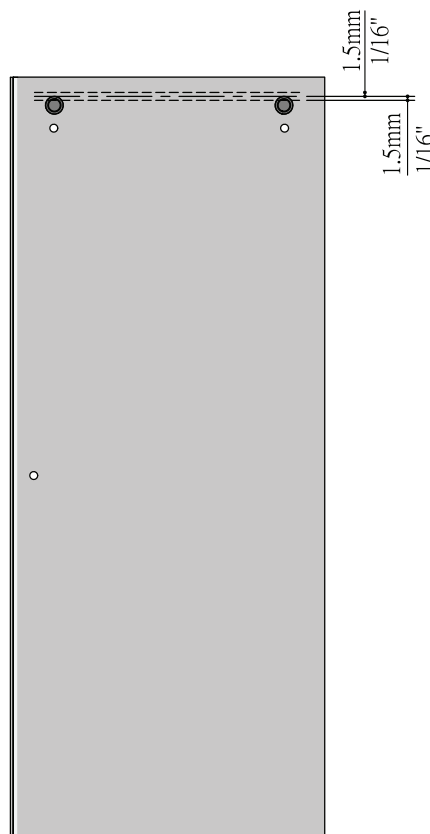
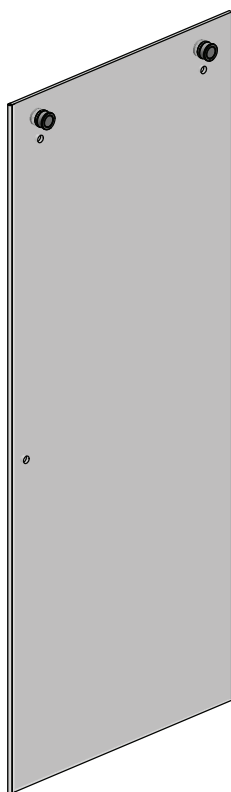

Install Top Roller (with bearing)



## STEP 8

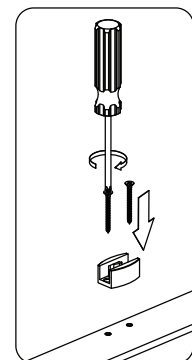
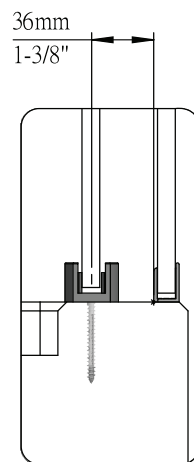
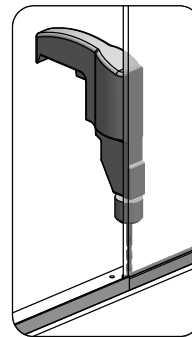
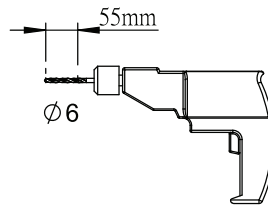
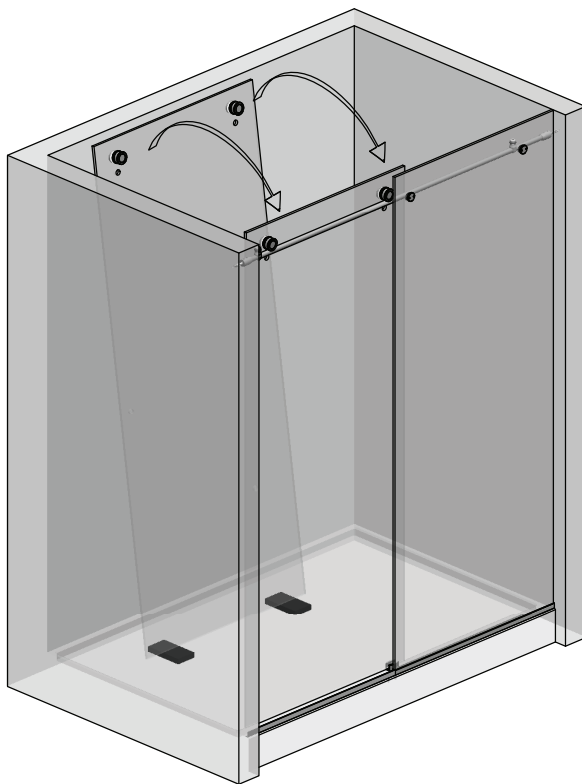

## STEP 9

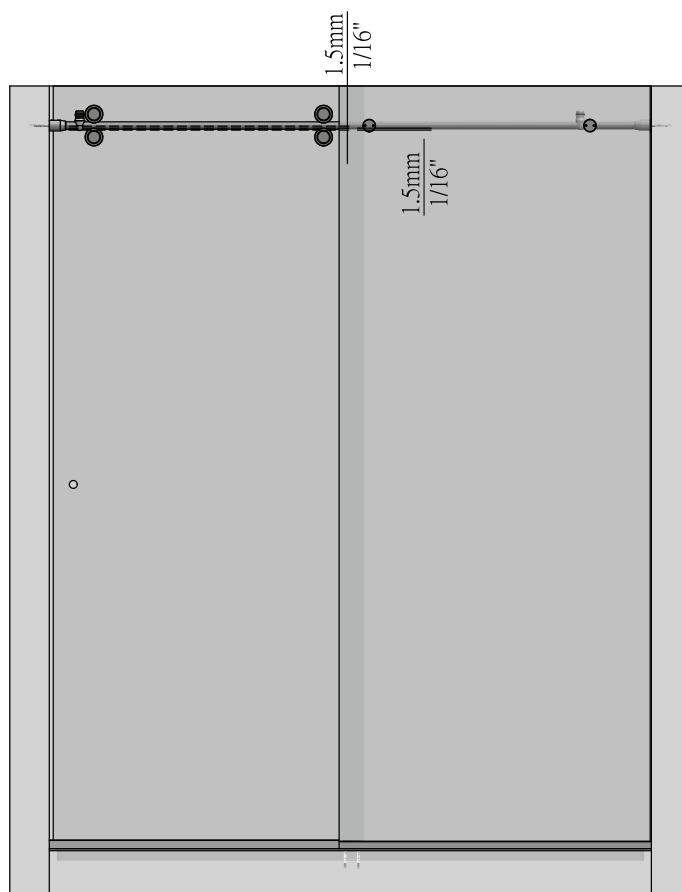
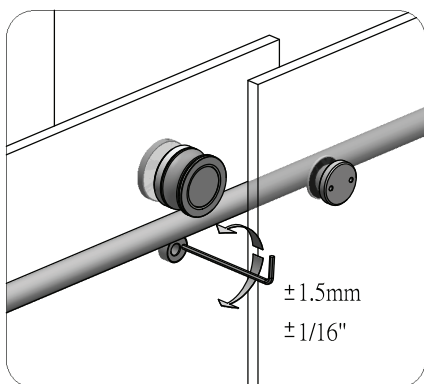

## STEP 10

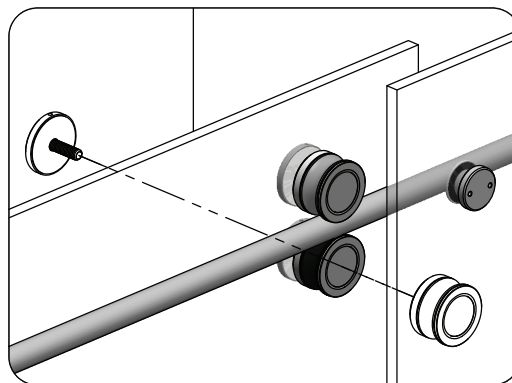
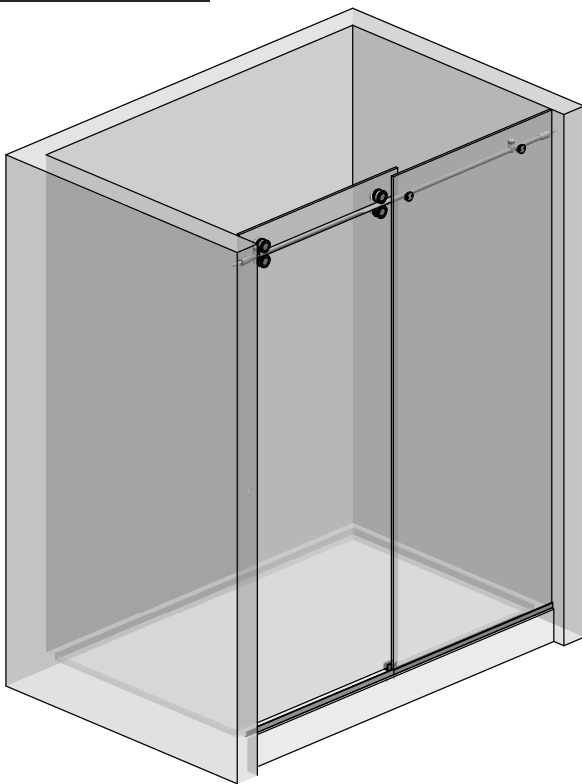

Install Bottom Anti-Lift Pin (without bearing)

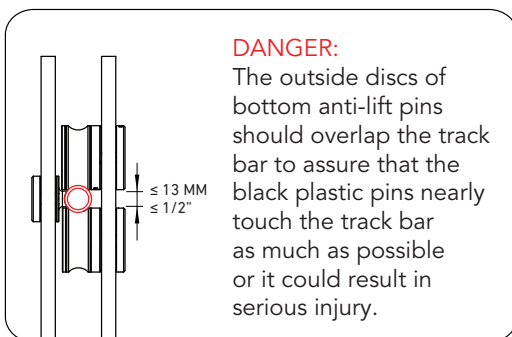

## STEP 11

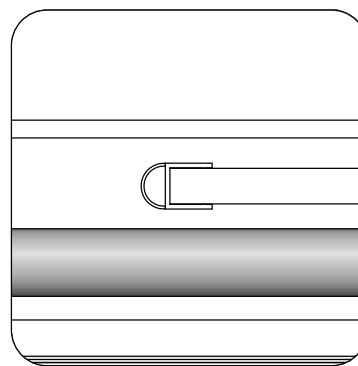
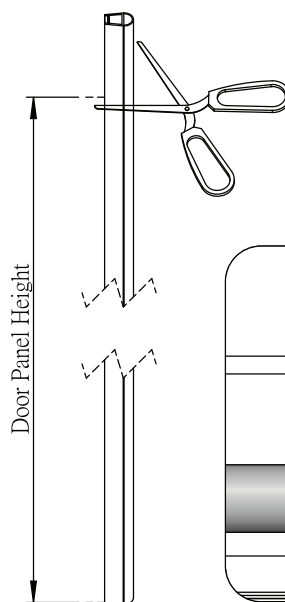
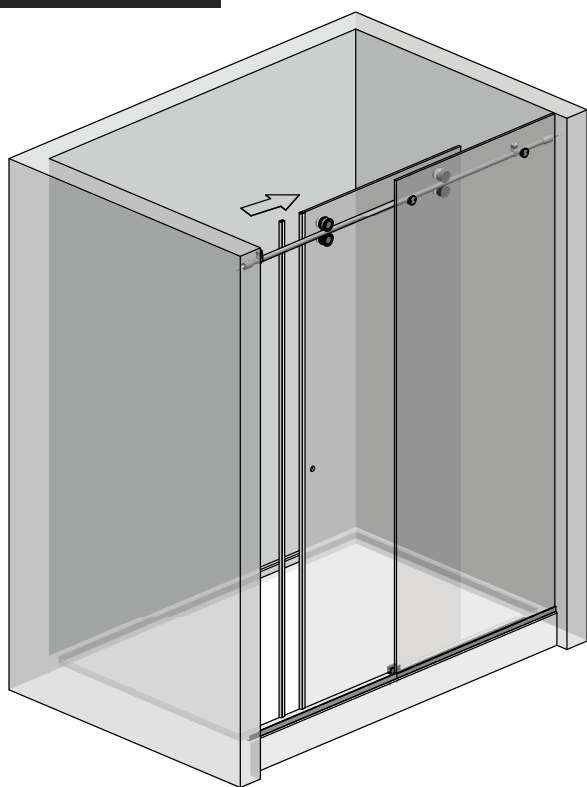

## STEP 12

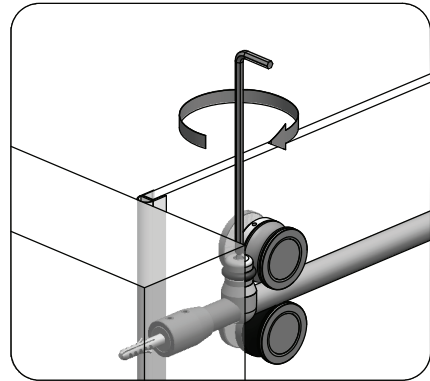
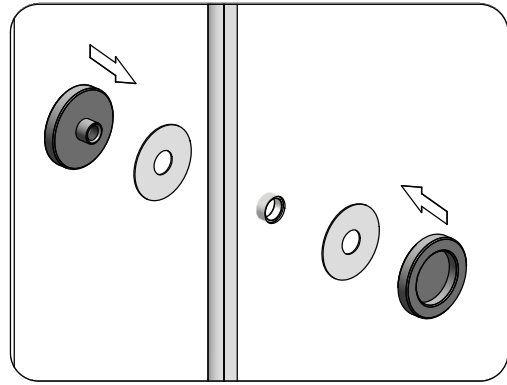
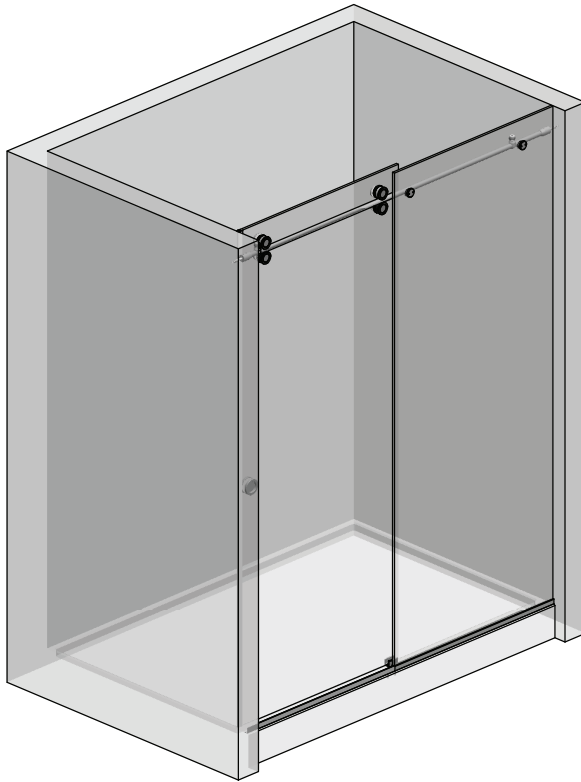

## STEP 13

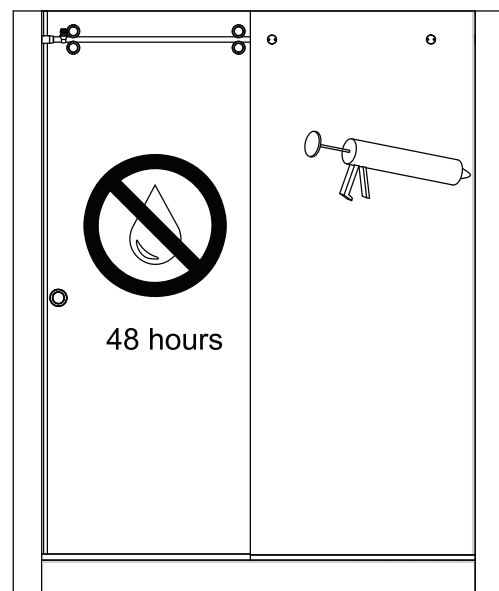
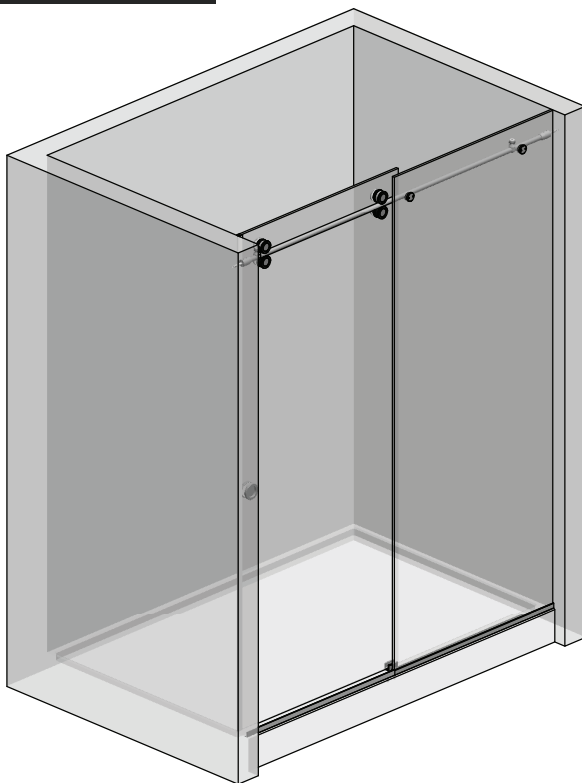

LET CAULKING CURE FOR 48 HOURS BEFORE USE