

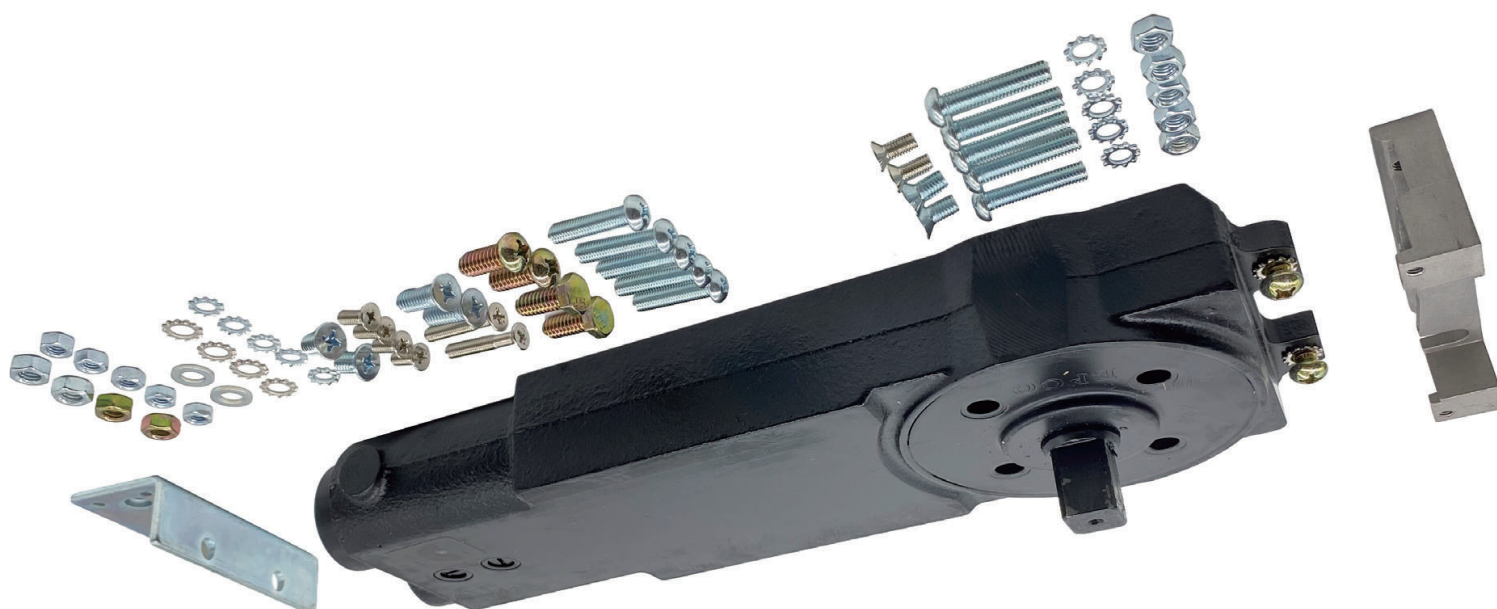

800 SERIES

OVERHEAD CONCEALED DOOR CLOSER



MODEL: 80X-M (80XL) FOR FRAMELESS DOOR

E: info@epcocorp.com W: www.epcocorp.com

© Copyright 2022-2023 EPCO Architectural Hardware (USA) Inc. - All right reserved. Usage strictly limited to contract condition more information please contact us through email info@epcocorp.com



**EPCO USA
ARCHITECTURAL
HARDWARE
SOLUTIONS**

800 SERIES

OVERHEAD CONCEALED DOOR CLOSER

- 5-year Warranty
- Double or Single Swing Door by Center Hung
(Apply door stopper for single swing door).
- Stay at closed position and resist to wind under correct closing size
- Compact size 88 mm x 293 mm (3-7/16" x 11-9/16")

TECHINICAL INFORMATION

- Closer Unit Strength

Door Width	Closing Size	Closing Force
Up to 750mm(29.5")	ANSI 2	16 Nm
751 to 950mm(29.5" to 37.4")	ANSI 3	25 Nm
951 to 1100mm(37.4" to 43.3")	ANSI 4	33 Nm

- Hold Open & Open Degree

Hold Open	Open Degree
No Hold	90°
90°	105°
105°	130°

- Backcheck 85° - 130°
- Self-Adhesive Labels
"DO NOT DRILL THIS AREA"
- 65 mm (2-9/16")/70 mm (2-3/4")
Pivot Point Fixing
Product Code 800-0031
- Closing & Latching Control Valves

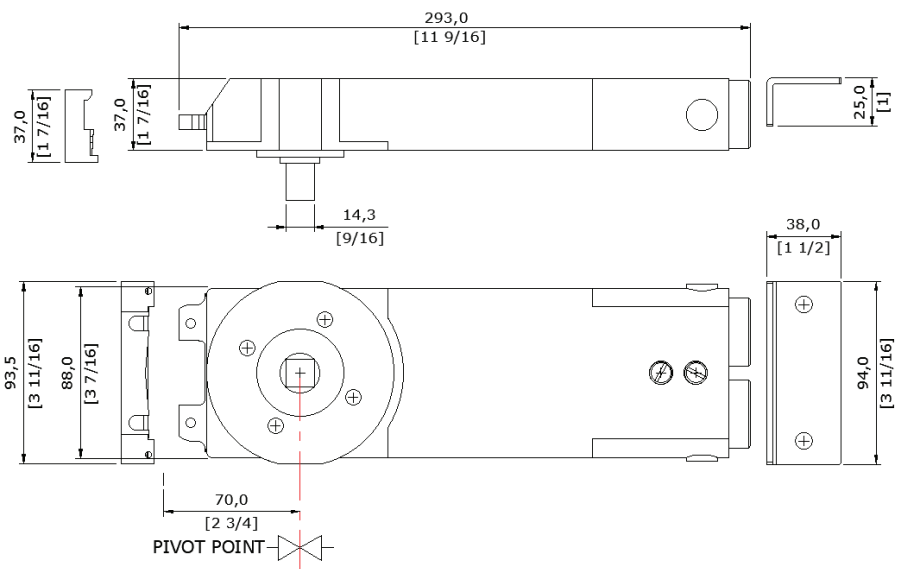

CLOSING ADJUSTMENT

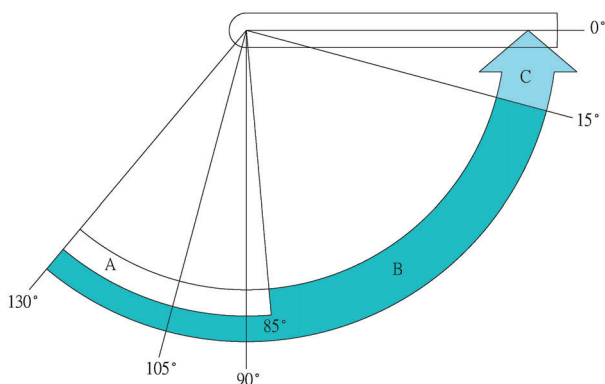

A	BACK CHECK
B	CLOSING RANGE
C	LATCHING RANGE



EPCO USA
ARCHITECTURAL
HARDWARE
SOLUTIONS

800 SERIES

OVERHEAD CONCEALED DOOR CLOSER

INSTALLATION: FRAMELESS DOOR WITH PATCH HARDWARE

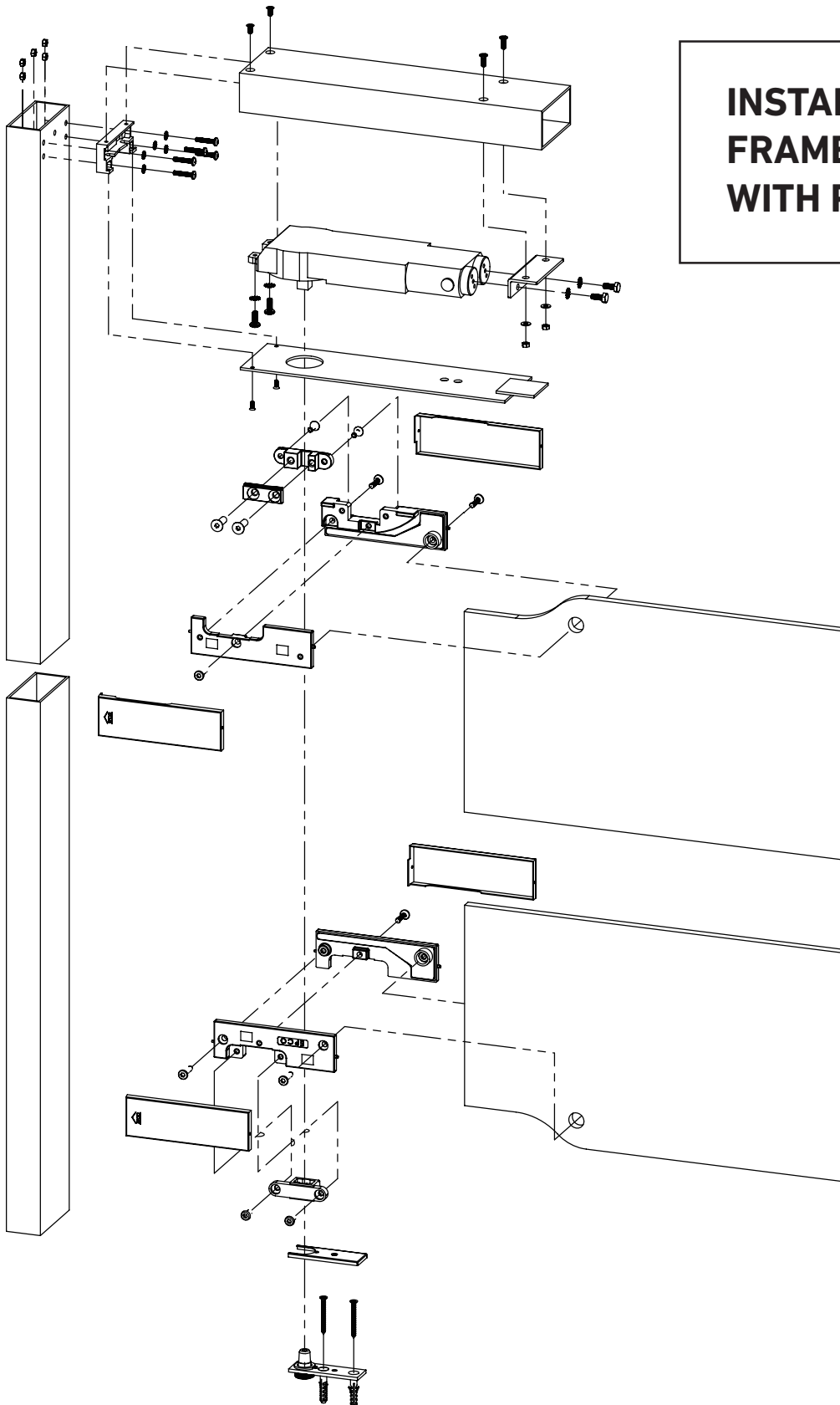

EPCO USA
ARCHITECTURAL
HARDWARE
SOLUTIONS